

面板背视

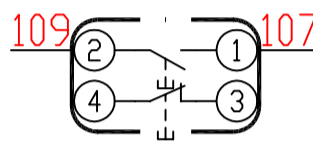

转换开关接点

	就地	远方
1-2		×
3-4	×	
5-6		×
7-8	×	

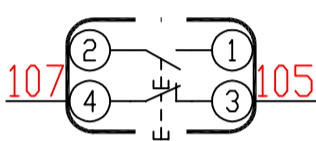
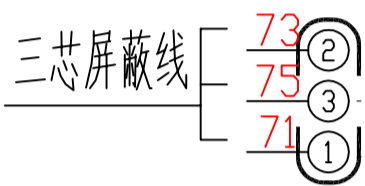
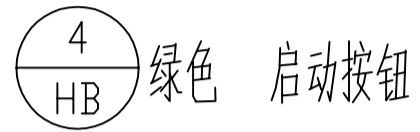
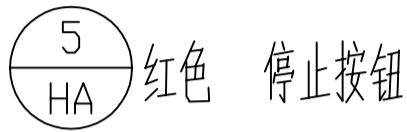
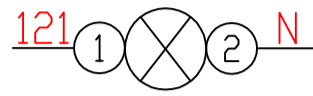
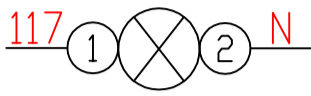
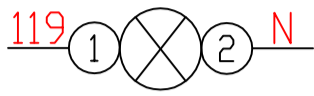
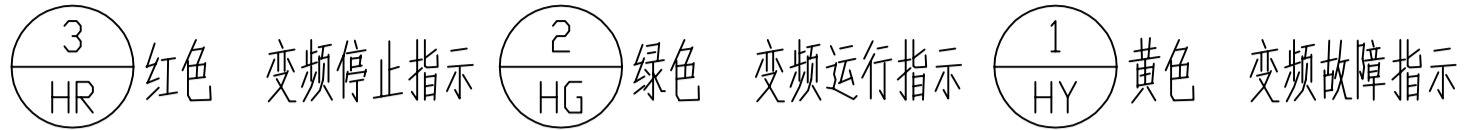
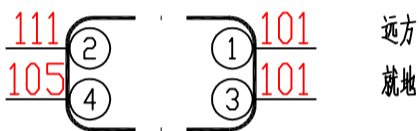

柜内如多回路，

需在线号前加“1-;2-”

N 至零排，零线也需区分，线号前加“1-N,2-N”

I		
1	101	
2		
3	107	
4	109	
5	111	
6	117	
7	119	
8	121	
9	N	
10		
11		N
12	71	
13	73	
14	75	
15	屏蔽层	
16		

V2 按钮箱接线图			
审核	设计	日期	2025.01
审核	审核	日期	
审核	日期	2025.01	

由 Autodesk 教育版产品制作